

Side Steering Mount

Accessory for Dyn X Simulator Cockpit
User Manual

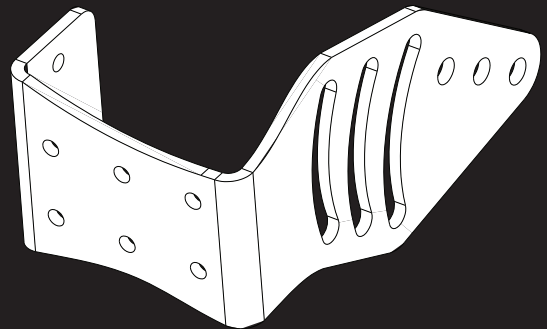
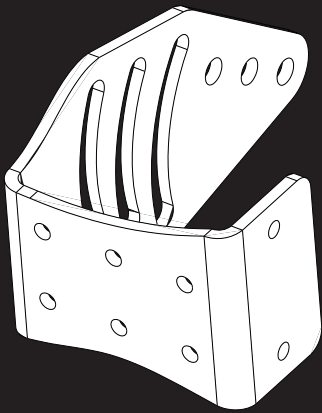

ATTACH STEERING MOUNT

TOOL

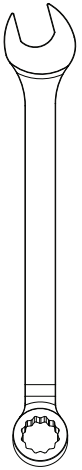

19mm

HARDWARE (INCLUDED WITH DYN X SIMULATOR COCKPIT)

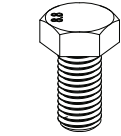

4x
M12 X 25mm
HEX HEAD SCREW

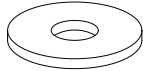

8x
M12 WASHER



2x
M12 DOUBLE T-SLOT NUT

STEP 1: ASSEMBLE STEERING MOUNT

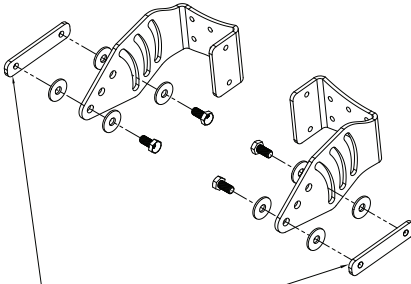

DOUBLE T-SLOT NUTS

PART



1x
LEFT SIDE MOUNT

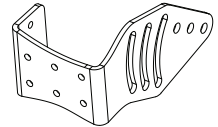

1x
RIGHT SIDE MOUNT

STEP 2: ATTACH STEERING MOUNTS TO WHEEL BASE

STEP 3: ATTACH STEERING MOUNTS TO COCKPIT BY INSERTING DOUBLE T-SLOT NUTS INTO STEERING MOUNT RAIL SLOTS

STEP 4: TIGHTEN SCREWS WHEN STEERING MOUNTS ARE AT THE DESIRED LOCATION

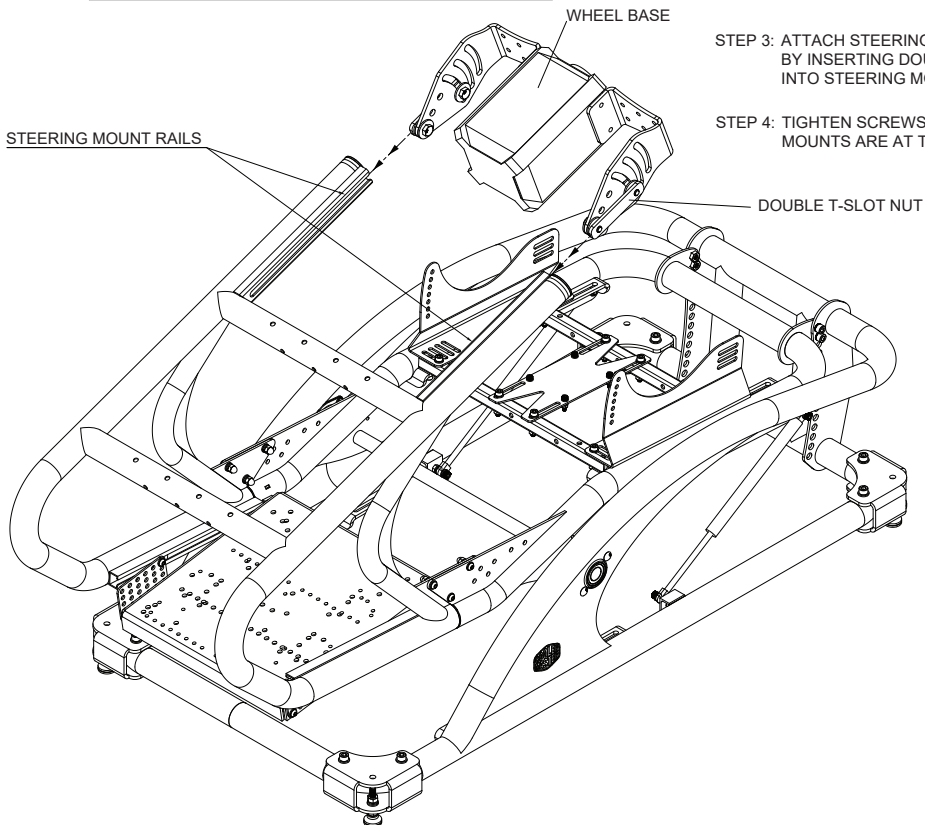

STEERING MOUNT OPTIONS

THERE ARE 3 REGULAR AND 3 INVERTED MOUNTING OPTIONS

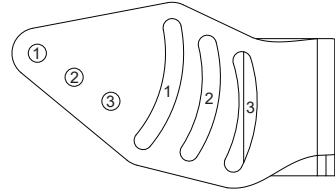
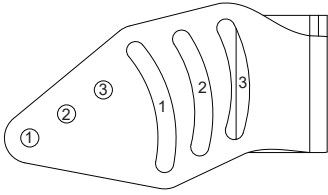

REGULAR - POSITION #1 (DEFAULT)

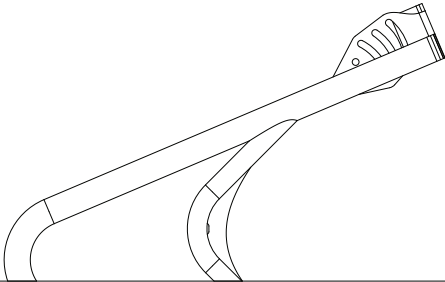

INVERTED - POSITION #1

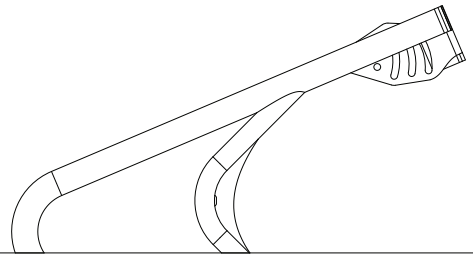

REGULAR - POSITION #2

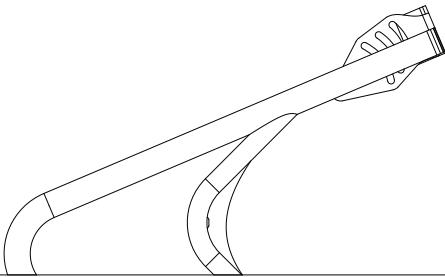

INVERTED - POSITION #2

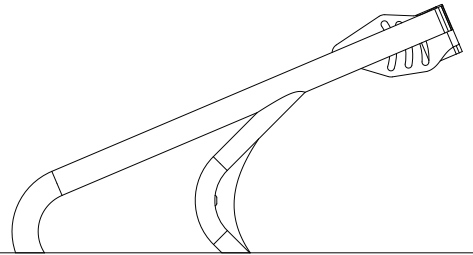

REGULAR - POSITION #3

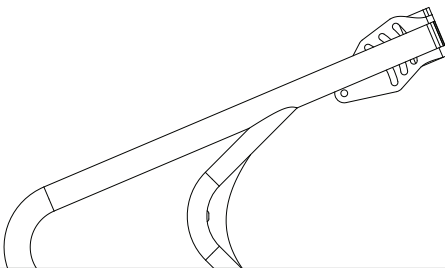

INVERTED - POSITION #3

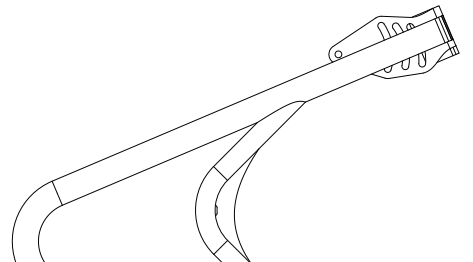

WARRANTY

Please visit: www.coolermaster.com for the terms of the warranty.